

- DC Voltage: -10 – +11V DC
- Minimum span: 5mV
- Zero suppression/elevation: Max. 1.5 times span
- Load resistance: Output drive 1mA maximum; at $\geq 0.5V$

Output	Load Resistance
0 – 10mV	: 10k (Ω minimum)
0 – 100mV	: 100k
0 – 1V	: 1000
0 – 10V	: 10k
0 – 5V	: 5000
1 – 5V	: 5000
-10 – +10V	: 10k
-5 – +5V	: 5000

INSTALLATION

Power input

AC: Operational voltage range 90 – 264V;
47 – 66 Hz; approx. 2VA at 100V
approx. 3VA at 200V
approx. 3VA at 264V

DC: Operational voltage range for R: 24V DC
 $\pm 10\%$, AD: 21.6 – 264V DC
approx. 1W; ripple 10% p-p max.

Operating temperature: -10 to +55°C (14 to 131°F)

Operating humidity: 30 to 90% RH (non-condensing)

Mounting: DIN rail

Dimensions: W12xH106xD110.5 mm (0.47"x4.17"x4.35")

Weight: 100 g (0.22 lbs)

PERFORMANCE

Accuracy: $\pm 0.2\%$

Temp. coefficient: $\pm 0.015\%/^{\circ}C$ ($\pm 0.008\%/^{\circ}F$)

Response time: ≤ 0.5 seconds (0 – 90%)

Approx. 25 milliseconds with option /K

Burnout response: ≤ 10 seconds

Line voltage effect: $\pm 0.1\%$ over voltage range

Insulation resistance: $\geq 100M\Omega$ with 500V DC

Dielectric strength: 2000V AC @1 minute

(input to output to power to ground)

STANDARDS & APPROVALS

CE conformity: EMC Directive (89/336/EEC)

EMI EN61000-6-4

EMS EN61000-6-2

Low Voltage Directive (73/23/EEC)

Installation category II

Pollution degree 2

Max. operating voltage 300V

Input or output to power – Reinforced insulation

Input to output – Basic insulation

SCHEMATIC CIRCUITRY & CONNECTION DIAGRAM

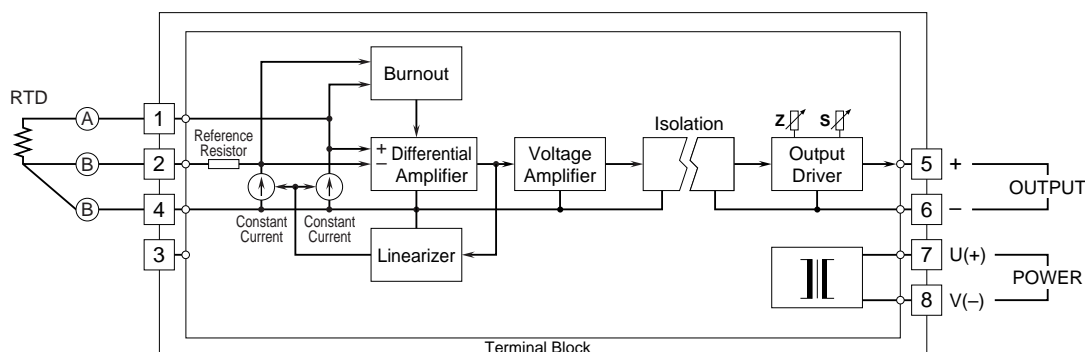

EXTERNAL DIMENSIONS & TERMINAL ASSIGNMENTS mm (inch)

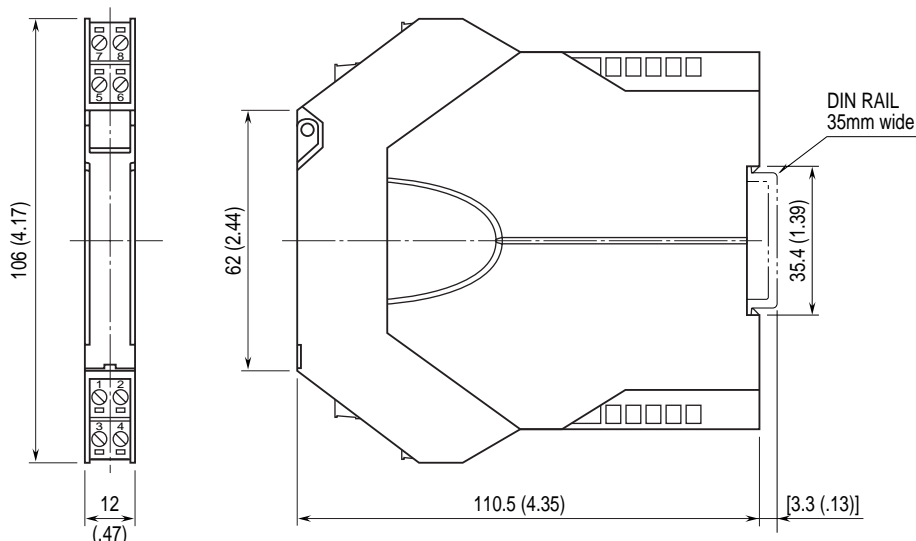

•When mounting, no extra space is needed between units.

Specifications subject to change without notice.